

ANALYTICAL REPORT

Job Number: 420-108512-1
SDG Number: Monticello - High School
Job Description: Sullivan County BOCES

For:
Sullivan County BOCES
6 Weirk Avenue
Liberty, NY 12754

Attention: Jesse Morrill



Meredith W Ruthven
Customer Service Manager
mruthven@envirotestlaboratories.com
08/16/2016

NYSDOH ELAP does not certify for all parameters. EnviroTest Laboratories does hold certification for all analytes where certification is offered by ELAP unless otherwise specified in the Certification Information section of this report. Pursuant to NELAP, this report may not be reproduced, except in full, without written approval of the laboratory. EnviroTest Laboratories Inc. certifies that the analytical results contained herein apply only to the samples tested as received by our laboratory. All questions regarding this report should be directed to the EnviroTest Customer Service Representative.

EnviroTest Laboratories, Inc. Certifications and Approvals: NYSDOH 10142, NJDEP NY015, CTDOH PH-0554

METHOD SUMMARY

Client: Sullivan County BOCES

Job Number: 420-108512-1
SDG Number: Monticello - High School

Description	Lab Location	Method	Preparation Method
Matrix: Water			
ICPMS Metals by 200.8	EnvTest	EPA 200.8 Rev.5.4	
200 Series Drinking Water Prep Determination Step	EnvTest		EPA 200

Lab References:

EnvTest = EnviroTest

Method References:

EPA = US Environmental Protection Agency

METHOD / ANALYST SUMMARY

Client: Sullivan County BOCES

Job Number: 420-108512-1
SDG Number: Monticello - High School

Method	Analyst	Analyst ID
EPA 200.8 Rev.5.4	Lerro, Matthew N	MnL
EPA 200.8 Rev.5.4	Sirico, Derek	DS

SAMPLE SUMMARY

Client: Sullivan County BOCES

Job Number: 420-108512-1
SDG Number: Monticello - High School

Lab Sample ID	Client Sample ID	Client Matrix	Date/Time Sampled	Date/Time Received
420-108512-1	603-F1	Drinking Water	08/05/2016 1005	08/05/2016 1605
420-108512-2	603-F2	Drinking Water	08/05/2016 1005	08/05/2016 1605
420-108512-3	612-F1	Drinking Water	08/05/2016 1005	08/05/2016 1605
420-108512-4	612-F2	Drinking Water	08/05/2016 1005	08/05/2016 1605
420-108512-5	AP-F1	Drinking Water	08/05/2016 1005	08/05/2016 1605
420-108512-6	AP-F2	Drinking Water	08/05/2016 1005	08/05/2016 1605
420-108512-7	305-F1	Drinking Water	08/05/2016 1005	08/05/2016 1605
420-108512-8	305-F2	Drinking Water	08/05/2016 1005	08/05/2016 1605
420-108512-9	204-F1	Drinking Water	08/05/2016 1005	08/05/2016 1605
420-108512-10	204-F2	Drinking Water	08/05/2016 1005	08/05/2016 1605
420-108512-11	200-F1	Drinking Water	08/05/2016 1005	08/05/2016 1605
420-108512-12	200-F2	Drinking Water	08/05/2016 1005	08/05/2016 1605
420-108512-13	226-F1	Drinking Water	08/05/2016 1005	08/05/2016 1605
420-108512-14	226-F2	Drinking Water	08/05/2016 1005	08/05/2016 1605
420-108512-15	231-S1	Drinking Water	08/05/2016 1005	08/05/2016 1605
420-108512-16	231-S2	Drinking Water	08/05/2016 1005	08/05/2016 1605
420-108512-17	221-F1	Drinking Water	08/05/2016 1005	08/05/2016 1605
420-108512-18	221-F2	Drinking Water	08/05/2016 1005	08/05/2016 1605
420-108512-19	110-F1	Drinking Water	08/05/2016 1005	08/05/2016 1605
420-108512-20	110-F2	Drinking Water	08/05/2016 1005	08/05/2016 1605
420-108512-21	115-F1	Drinking Water	08/05/2016 1005	08/05/2016 1605
420-108512-22	115-F2	Drinking Water	08/05/2016 1005	08/05/2016 1605
420-108512-23	GYM-F1	Drinking Water	08/05/2016 1005	08/05/2016 1605
420-108512-24	GYM-F2	Drinking Water	08/05/2016 1005	08/05/2016 1605
420-108512-25	507-F1	Drinking Water	08/05/2016 1005	08/05/2016 1605
420-108512-26	507-F2	Drinking Water	08/05/2016 1005	08/05/2016 1605
420-108512-27	CAF1-F1	Drinking Water	08/05/2016 1005	08/05/2016 1605
420-108512-28	CAF1-F2	Drinking Water	08/05/2016 1005	08/05/2016 1605
420-108512-29	CAF2-F1	Drinking Water	08/05/2016 1005	08/05/2016 1605
420-108512-30	CAF2-F2	Drinking Water	08/05/2016 1005	08/05/2016 1605
420-108512-31	Kit1-S1	Drinking Water	08/05/2016 1005	08/05/2016 1605
420-108512-32	Kit1-S2	Drinking Water	08/05/2016 1005	08/05/2016 1605
420-108512-33	Kit2-S1	Drinking Water	08/05/2016 1005	08/05/2016 1605
420-108512-34	Kit2-S2	Drinking Water	08/05/2016 1005	08/05/2016 1605

Jesse Morrill
Sullivan County BOCES
6 Weirk Avenue
Liberty, NY 12754

Job Number: 420-108512-1
Sdg Number: Monticello - High School

Client Sample ID: 603-F1
Lab Sample ID: 420-108512-1

Date Sampled: 08/05/2016 1005
Date Received: 08/05/2016 1605
Client Matrix: Drinking Water

Analyte	Result/Qualifier	Unit	RL	RL	Dilution
Method: 200.8 Rev.5.4			Date Analyzed: 08/14/2016 1809		
Prep Method: 200			Date Prepared: 08/13/2016 1400		
Pb	1.00 U	ug/L	1.00	1.00	1.0

Jesse Morrill
Sullivan County BOCES
6 Weirk Avenue
Liberty, NY 12754

Job Number: 420-108512-1
Sdg Number: Monticello - High School

Client Sample ID: 603-F2
Lab Sample ID: 420-108512-2

Date Sampled: 08/05/2016 1005
Date Received: 08/05/2016 1605
Client Matrix: Drinking Water

Analyte	Result/Qualifier	Unit	RL	RL	Dilution
Method: 200.8 Rev.5.4			Date Analyzed: 08/14/2016 1813		
Prep Method: 200			Date Prepared: 08/13/2016 1400		
Pb	1.00 U	ug/L	1.00	1.00	1.0

Jesse Morrill
Sullivan County BOCES
6 Weirk Avenue
Liberty, NY 12754

Job Number: 420-108512-1
Sdg Number: Monticello - High School

Client Sample ID: 612-F1
Lab Sample ID: 420-108512-3

Date Sampled: 08/05/2016 1005
Date Received: 08/05/2016 1605
Client Matrix: Drinking Water

Analyte	Result/Qualifier	Unit	RL	RL	Dilution
Method: 200.8 Rev.5.4			Date Analyzed: 08/14/2016 1823		
Prep Method: 200			Date Prepared: 08/13/2016 1400		
Pb	1.00 U	ug/L	1.00	1.00	1.0

Jesse Morrill
Sullivan County BOCES
6 Weirk Avenue
Liberty, NY 12754

Job Number: 420-108512-1
Sdg Number: Monticello - High School

Client Sample ID: 612-F2
Lab Sample ID: 420-108512-4

Date Sampled: 08/05/2016 1005
Date Received: 08/05/2016 1605
Client Matrix: Drinking Water

Analyte	Result/Qualifier	Unit	RL	RL	Dilution
Method: 200.8 Rev.5.4			Date Analyzed: 08/14/2016 1827		
Prep Method: 200			Date Prepared: 08/13/2016 1400		
Pb	1.00 U	ug/L	1.00	1.00	1.0

Jesse Morrill
Sullivan County BOCES
6 Weirk Avenue
Liberty, NY 12754

Job Number: 420-108512-1
Sdg Number: Monticello - High School

Client Sample ID: AP-F1
Lab Sample ID: 420-108512-5

Date Sampled: 08/05/2016 1005
Date Received: 08/05/2016 1605
Client Matrix: Drinking Water

Analyte	Result/Qualifier	Unit	RL	RL	Dilution
Method: 200.8 Rev.5.4			Date Analyzed: 08/14/2016 1830		
Prep Method: 200			Date Prepared: 08/13/2016 1400		
Pb	1.00 U	ug/L	1.00	1.00	1.0

Jesse Morrill
Sullivan County BOCES
6 Weirk Avenue
Liberty, NY 12754

Job Number: 420-108512-1
Sdg Number: Monticello - High School

Client Sample ID: AP-F2
Lab Sample ID: 420-108512-6

Date Sampled: 08/05/2016 1005
Date Received: 08/05/2016 1605
Client Matrix: Drinking Water

Analyte	Result/Qualifier	Unit	RL	RL	Dilution
Method: 200.8 Rev.5.4			Date Analyzed: 08/14/2016 1834		
Prep Method: 200			Date Prepared: 08/13/2016 1400		
Pb	1.00 U	ug/L	1.00	1.00	1.0

Jesse Morrill
Sullivan County BOCES
6 Weirk Avenue
Liberty, NY 12754

Job Number: 420-108512-1
Sdg Number: Monticello - High School

Client Sample ID: 305-F1
Lab Sample ID: 420-108512-7

Date Sampled: 08/05/2016 1005
Date Received: 08/05/2016 1605
Client Matrix: Drinking Water

Analyte	Result/Qualifier	Unit	RL	RL	Dilution
Method: 200.8 Rev.5.4			Date Analyzed: 08/14/2016 1837		
Prep Method: 200			Date Prepared: 08/13/2016 1400		
Pb	1.03	ug/L	1.00	1.00	1.0

Jesse Morrill
Sullivan County BOCES
6 Weirk Avenue
Liberty, NY 12754

Job Number: 420-108512-1
Sdg Number: Monticello - High School

Client Sample ID: 305-F2
Lab Sample ID: 420-108512-8

Date Sampled: 08/05/2016 1005
Date Received: 08/05/2016 1605
Client Matrix: Drinking Water

Analyte	Result/Qualifier	Unit	RL	RL	Dilution
Method: 200.8 Rev.5.4			Date Analyzed: 08/14/2016 1841		
Prep Method: 200			Date Prepared: 08/13/2016 1400		
Pb	2.94	ug/L	1.00	1.00	1.0

Jesse Morrill
Sullivan County BOCES
6 Weirk Avenue
Liberty, NY 12754

Job Number: 420-108512-1
Sdg Number: Monticello - High School

Client Sample ID: 204-F1
Lab Sample ID: 420-108512-9

Date Sampled: 08/05/2016 1005
Date Received: 08/05/2016 1605
Client Matrix: Drinking Water

Analyte	Result/Qualifier	Unit	RL	RL	Dilution
Method: 200.8 Rev.5.4			Date Analyzed: 08/14/2016 1844		
Prep Method: 200			Date Prepared: 08/13/2016 1400		
Pb	1.00 U	ug/L	1.00	1.00	1.0

Jesse Morrill
Sullivan County BOCES
6 Weirk Avenue
Liberty, NY 12754

Job Number: 420-108512-1
Sdg Number: Monticello - High School

Client Sample ID: 204-F2
Lab Sample ID: 420-108512-10

Date Sampled: 08/05/2016 1005
Date Received: 08/05/2016 1605
Client Matrix: Drinking Water

Analyte	Result/Qualifier	Unit	RL	RL	Dilution
Method: 200.8 Rev.5.4			Date Analyzed: 08/14/2016 1848		
Prep Method: 200			Date Prepared: 08/13/2016 1400		
Pb	1.00 U	ug/L	1.00	1.00	1.0

Jesse Morrill
Sullivan County BOCES
6 Weirk Avenue
Liberty, NY 12754

Job Number: 420-108512-1
Sdg Number: Monticello - High School

Client Sample ID: 200-F1
Lab Sample ID: 420-108512-11

Date Sampled: 08/05/2016 1005
Date Received: 08/05/2016 1605
Client Matrix: Drinking Water

Analyte	Result/Qualifier	Unit	RL	RL	Dilution
Method: 200.8 Rev.5.4			Date Analyzed: 08/14/2016 1851		
Prep Method: 200			Date Prepared: 08/13/2016 1400		
Pb	1.00 U	ug/L	1.00	1.00	1.0

Jesse Morrill
Sullivan County BOCES
6 Weirk Avenue
Liberty, NY 12754

Job Number: 420-108512-1
Sdg Number: Monticello - High School

Client Sample ID: 200-F2
Lab Sample ID: 420-108512-12

Date Sampled: 08/05/2016 1005
Date Received: 08/05/2016 1605
Client Matrix: Drinking Water

Analyte	Result/Qualifier	Unit	RL	RL	Dilution
Method: 200.8 Rev.5.4			Date Analyzed: 08/14/2016 1855		
Prep Method: 200			Date Prepared: 08/13/2016 1400		
Pb	1.00 U	ug/L	1.00	1.00	1.0

Jesse Morrill
Sullivan County BOCES
6 Weirk Avenue
Liberty, NY 12754

Job Number: 420-108512-1
Sdg Number: Monticello - High School

Client Sample ID: 226-F1
Lab Sample ID: 420-108512-13

Date Sampled: 08/05/2016 1005
Date Received: 08/05/2016 1605
Client Matrix: Drinking Water

Analyte	Result/Qualifier	Unit	RL	RL	Dilution
Method: 200.8 Rev.5.4			Date Analyzed: 08/14/2016 1905		
Prep Method: 200			Date Prepared: 08/13/2016 1400		
Pb	2.50	ug/L	1.00	1.00	1.0

Jesse Morrill
Sullivan County BOCES
6 Weirk Avenue
Liberty, NY 12754

Job Number: 420-108512-1
Sdg Number: Monticello - High School

Client Sample ID: 226-F2
Lab Sample ID: 420-108512-14

Date Sampled: 08/05/2016 1005
Date Received: 08/05/2016 1605
Client Matrix: Drinking Water

Analyte	Result/Qualifier	Unit	RL	RL	Dilution
Method: 200.8 Rev.5.4			Date Analyzed: 08/14/2016 1909		
Prep Method: 200			Date Prepared: 08/13/2016 1400		
Pb	2.43	ug/L	1.00	1.00	1.0

Jesse Morrill
Sullivan County BOCES
6 Weirk Avenue
Liberty, NY 12754

Job Number: 420-108512-1
Sdg Number: Monticello - High School

Client Sample ID: 231-S1
Lab Sample ID: 420-108512-15

Date Sampled: 08/05/2016 1005
Date Received: 08/05/2016 1605
Client Matrix: Drinking Water

Analyte	Result/Qualifier	Unit	RL	RL	Dilution
Method: 200.8 Rev.5.4			Date Analyzed: 08/14/2016 1912		
Prep Method: 200			Date Prepared: 08/13/2016 1400		
Pb	1.00 U	ug/L	1.00	1.00	1.0

Jesse Morrill
Sullivan County BOCES
6 Weirk Avenue
Liberty, NY 12754

Job Number: 420-108512-1
Sdg Number: Monticello - High School

Client Sample ID: 231-S2
Lab Sample ID: 420-108512-16

Date Sampled: 08/05/2016 1005
Date Received: 08/05/2016 1605
Client Matrix: Drinking Water

Analyte	Result/Qualifier	Unit	RL	RL	Dilution
Method: 200.8 Rev.5.4			Date Analyzed: 08/14/2016 1916		
Prep Method: 200			Date Prepared: 08/13/2016 1430		
Pb	1.00 U	ug/L	1.00	1.00	1.0

Jesse Morrill
Sullivan County BOCES
6 Weirk Avenue
Liberty, NY 12754

Job Number: 420-108512-1
Sdg Number: Monticello - High School

Client Sample ID: 221-F1
Lab Sample ID: 420-108512-17

Date Sampled: 08/05/2016 1005
Date Received: 08/05/2016 1605
Client Matrix: Drinking Water

Analyte	Result/Qualifier	Unit	RL	RL	Dilution
Method: 200.8 Rev.5.4			Date Analyzed: 08/14/2016 1930		
Prep Method: 200			Date Prepared: 08/13/2016 1430		
Pb	1.00 U	ug/L	1.00	1.00	1.0

Jesse Morrill
Sullivan County BOCES
6 Weirk Avenue
Liberty, NY 12754

Job Number: 420-108512-1
Sdg Number: Monticello - High School

Client Sample ID: 221-F2
Lab Sample ID: 420-108512-18

Date Sampled: 08/05/2016 1005
Date Received: 08/05/2016 1605
Client Matrix: Drinking Water

Analyte	Result/Qualifier	Unit	RL	RL	Dilution
Method: 200.8 Rev.5.4			Date Analyzed: 08/14/2016 1933		
Prep Method: 200			Date Prepared: 08/13/2016 1430		
Pb	1.00 U	ug/L	1.00	1.00	1.0

Jesse Morrill
Sullivan County BOCES
6 Weirk Avenue
Liberty, NY 12754

Job Number: 420-108512-1
Sdg Number: Monticello - High School

Client Sample ID: 110-F1
Lab Sample ID: 420-108512-19

Date Sampled: 08/05/2016 1005
Date Received: 08/05/2016 1605
Client Matrix: Drinking Water

Analyte	Result/Qualifier	Unit	RL	RL	Dilution
Method: 200.8 Rev.5.4			Date Analyzed: 08/14/2016 1937		
Prep Method: 200			Date Prepared: 08/13/2016 1430		
Pb	1.00 U	ug/L	1.00	1.00	1.0

Jesse Morrill
Sullivan County BOCES
6 Weirk Avenue
Liberty, NY 12754

Job Number: 420-108512-1
Sdg Number: Monticello - High School

Client Sample ID: 110-F2
Lab Sample ID: 420-108512-20

Date Sampled: 08/05/2016 1005
Date Received: 08/05/2016 1605
Client Matrix: Drinking Water

Analyte	Result/Qualifier	Unit	RL	RL	Dilution
Method: 200.8 Rev.5.4			Date Analyzed: 08/14/2016 1947		
Prep Method: 200			Date Prepared: 08/13/2016 1430		
Pb	1.00 U	ug/L	1.00	1.00	1.0

Jesse Morrill
Sullivan County BOCES
6 Weirk Avenue
Liberty, NY 12754

Job Number: 420-108512-1
Sdg Number: Monticello - High School

Client Sample ID: 115-F1
Lab Sample ID: 420-108512-21

Date Sampled: 08/05/2016 1005
Date Received: 08/05/2016 1605
Client Matrix: Drinking Water

Analyte	Result/Qualifier	Unit	RL	RL	Dilution
Method: 200.8 Rev.5.4			Date Analyzed: 08/14/2016 1951		
Prep Method: 200			Date Prepared: 08/13/2016 1430		
Pb	1.00 U	ug/L	1.00	1.00	1.0

Jesse Morrill
Sullivan County BOCES
6 Weirk Avenue
Liberty, NY 12754

Job Number: 420-108512-1
Sdg Number: Monticello - High School

Client Sample ID: 115-F2
Lab Sample ID: 420-108512-22

Date Sampled: 08/05/2016 1005
Date Received: 08/05/2016 1605
Client Matrix: Drinking Water

Analyte	Result/Qualifier	Unit	RL	RL	Dilution
Method: 200.8 Rev.5.4			Date Analyzed: 08/14/2016 1954		
Prep Method: 200			Date Prepared: 08/13/2016 1430		
Pb	1.00 U	ug/L	1.00	1.00	1.0

Jesse Morrill
Sullivan County BOCES
6 Weirk Avenue
Liberty, NY 12754

Job Number: 420-108512-1
Sdg Number: Monticello - High School

Client Sample ID: GYM-F1
Lab Sample ID: 420-108512-23

Date Sampled: 08/05/2016 1005
Date Received: 08/05/2016 1605
Client Matrix: Drinking Water

Analyte	Result/Qualifier	Unit	RL	RL	Dilution
Method: 200.8 Rev.5.4			Date Analyzed: 08/14/2016 1958		
Prep Method: 200			Date Prepared: 08/13/2016 1430		
Pb	1.00 U	ug/L	1.00	1.00	1.0

Jesse Morrill
Sullivan County BOCES
6 Weirk Avenue
Liberty, NY 12754

Job Number: 420-108512-1
Sdg Number: Monticello - High School

Client Sample ID: GYM-F2
Lab Sample ID: 420-108512-24

Date Sampled: 08/05/2016 1005
Date Received: 08/05/2016 1605
Client Matrix: Drinking Water

Analyte	Result/Qualifier	Unit	RL	RL	Dilution
Method: 200.8 Rev.5.4			Date Analyzed: 08/14/2016 2001		
Prep Method: 200			Date Prepared: 08/13/2016 1430		
Pb	1.00 U	ug/L	1.00	1.00	1.0

Jesse Morrill
Sullivan County BOCES
6 Weirk Avenue
Liberty, NY 12754

Job Number: 420-108512-1
Sdg Number: Monticello - High School

Client Sample ID: 507-F1
Lab Sample ID: 420-108512-25

Date Sampled: 08/05/2016 1005
Date Received: 08/05/2016 1605
Client Matrix: Drinking Water

Analyte	Result/Qualifier	Unit	RL	RL	Dilution
Method: 200.8 Rev.5.4			Date Analyzed: 08/14/2016 2005		
Prep Method: 200			Date Prepared: 08/13/2016 1430		
Pb	1.00 U	ug/L	1.00	1.00	1.0

Jesse Morrill
Sullivan County BOCES
6 Weirk Avenue
Liberty, NY 12754

Job Number: 420-108512-1
Sdg Number: Monticello - High School

Client Sample ID: 507-F2
Lab Sample ID: 420-108512-26

Date Sampled: 08/05/2016 1005
Date Received: 08/05/2016 1605
Client Matrix: Drinking Water

Analyte	Result/Qualifier	Unit	RL	RL	Dilution
Method: 200.8 Rev.5.4			Date Analyzed: 08/14/2016 2008		
Prep Method: 200			Date Prepared: 08/13/2016 1430		
Pb	1.00 U	ug/L	1.00	1.00	1.0

Jesse Morrill
Sullivan County BOCES
6 Weirk Avenue
Liberty, NY 12754

Job Number: 420-108512-1
Sdg Number: Monticello - High School

Client Sample ID: CAF1-F1
Lab Sample ID: 420-108512-27

Date Sampled: 08/05/2016 1005
Date Received: 08/05/2016 1605
Client Matrix: Drinking Water

Analyte	Result/Qualifier	Unit	RL	RL	Dilution
Method: 200.8 Rev.5.4			Date Analyzed: 08/14/2016	2012	
Prep Method: 200			Date Prepared: 08/13/2016	1430	
Pb	1.00 U	ug/L	1.00	1.00	1.0

Jesse Morrill
Sullivan County BOCES
6 Weirk Avenue
Liberty, NY 12754

Job Number: 420-108512-1
Sdg Number: Monticello - High School

Client Sample ID: CAF1-F2
Lab Sample ID: 420-108512-28

Date Sampled: 08/05/2016 1005
Date Received: 08/05/2016 1605
Client Matrix: Drinking Water

Analyte	Result/Qualifier	Unit	RL	RL	Dilution
Method: 200.8 Rev.5.4			Date Analyzed: 08/14/2016	2015	
Prep Method: 200			Date Prepared: 08/13/2016	1430	
Pb	1.00 U	ug/L	1.00	1.00	1.0

Jesse Morrill
Sullivan County BOCES
6 Weirk Avenue
Liberty, NY 12754

Job Number: 420-108512-1
Sdg Number: Monticello - High School

Client Sample ID: CAF2-F1
Lab Sample ID: 420-108512-29

Date Sampled: 08/05/2016 1005
Date Received: 08/05/2016 1605
Client Matrix: Drinking Water

Analyte	Result/Qualifier	Unit	RL	RL	Dilution
Method: 200.8 Rev.5.4			Date Analyzed: 08/14/2016	2019	
Prep Method: 200			Date Prepared: 08/13/2016	1430	
Pb	1.00 U	ug/L	1.00	1.00	1.0

Jesse Morrill
Sullivan County BOCES
6 Weirk Avenue
Liberty, NY 12754

Job Number: 420-108512-1
Sdg Number: Monticello - High School

Client Sample ID: CAF2-F2
Lab Sample ID: 420-108512-30

Date Sampled: 08/05/2016 1005
Date Received: 08/05/2016 1605
Client Matrix: Drinking Water

Analyte	Result/Qualifier	Unit	RL	RL	Dilution
Method: 200.8 Rev.5.4			Date Analyzed: 08/14/2016 2030		
Prep Method: 200			Date Prepared: 08/13/2016 1430		
Pb	1.09	ug/L	1.00	1.00	1.0

Jesse Morrill
Sullivan County BOCES
6 Weirk Avenue
Liberty, NY 12754

Job Number: 420-108512-1
Sdg Number: Monticello - High School

Client Sample ID: Kit1-S1
Lab Sample ID: 420-108512-31

Date Sampled: 08/05/2016 1005
Date Received: 08/05/2016 1605
Client Matrix: Drinking Water

Analyte	Result/Qualifier	Unit	RL	RL	Dilution
Method: 200.8 Rev.5.4			Date Analyzed: 08/14/2016 2033		
Prep Method: 200			Date Prepared: 08/13/2016 1430		
Pb	2.69	ug/L	1.00	1.00	1.0

Jesse Morrill
Sullivan County BOCES
6 Weirk Avenue
Liberty, NY 12754

Job Number: 420-108512-1
Sdg Number: Monticello - High School

Client Sample ID: Kit1-S2
Lab Sample ID: 420-108512-32

Date Sampled: 08/05/2016 1005
Date Received: 08/05/2016 1605
Client Matrix: Drinking Water

Analyte	Result/Qualifier	Unit	RL	RL	Dilution
Method: 200.8 Rev.5.4			Date Analyzed: 08/14/2016 2037		
Prep Method: 200			Date Prepared: 08/13/2016 1430		
Pb	1.00 U	ug/L	1.00	1.00	1.0

Jesse Morrill
Sullivan County BOCES
6 Weirk Avenue
Liberty, NY 12754

Job Number: 420-108512-1
Sdg Number: Monticello - High School

Client Sample ID: Kit2-S1
Lab Sample ID: 420-108512-33

Date Sampled: 08/05/2016 1005
Date Received: 08/05/2016 1605
Client Matrix: Drinking Water

Analyte	Result/Qualifier	Unit	RL	RL	Dilution
Method: 200.8 Rev.5.4			Date Analyzed: 08/14/2016 2040		
Prep Method: 200			Date Prepared: 08/13/2016 1430		
Pb	21.3 g	ug/L	1.00	1.00	1.0

Jesse Morrill
Sullivan County BOCES
6 Weirk Avenue
Liberty, NY 12754

Job Number: 420-108512-1
Sdg Number: Monticello - High School

Client Sample ID: Kit2-S2
Lab Sample ID: 420-108512-34

Date Sampled: 08/05/2016 1005
Date Received: 08/05/2016 1605
Client Matrix: Drinking Water

Analyte	Result/Qualifier	Unit	RL	RL	Dilution
Method: 200.8 Rev.5.4			Date Analyzed: 08/15/2016 1528		
Prep Method: 200			Date Prepared: 08/13/2016 1430		
Pb	1.24	ug/L	1.00	1.00	1.0

DATA REPORTING QUALIFIERS

Client: Sullivan County BOCES

Job Number:
Sdg Number: Monticello - High School

Lab Section	Qualifier	Description
Metals	g	Result fails applicable NYS drinking water standards
	U	The analyte was analyzed for but not detected at or above the lowest stated limit.

Certification Information

Client: Sullivan County BOCES

Job Number:

Sdg Number: Monticello - High School

The following analytes are Not Part of the ELAP scope of accreditation:

Sulfur, Tungsten, Silicon, Bicarbonate Alkalinity, 7 Day BOD 5210C, 28 Day BOD, Soluble BOD, Carbon Dioxide, Carbonate Alkalinity, CBOD Soluble, Chlorine, Cyanide (WAD), Ferrous Iron, Ferric Iron, Total Nitrogen, Total Organic Nitrogen, Dissolved Oxygen, pH, Phenolphthalien Alkalinity, Solids (Fixed), Solids (Percent), Solids (Percent Moisture) , Solids (Percent Volatile), Solids (Volatile Suspended), Temperature, TKN (Soluble), Total Inorganic Carbon, Volatile Acids as Acetic Acid, 2-Aminopyridine, 3-Picoline, 1-Methyl-2-pyrrilidinone, Aziridine, Dimethyl sulfoxide, 1-Chlorohexane, Iron Bacteria, Salmonella, & Sulfur Reducing Bacteria.

The following analytes are Not Part of ELAP Potable Water scope of accreditation:

Cobalt (200.7, 200.8), Tin (200.7), Strontium (200.7), Gold (200.7), Platinum (200.7), Palladium (200.7), Titanium (200.7), Phosphorus (365.3), Nitrate-Nitrite (10-107-4-1C, 353.2), m-Xylene & p-Xylene (502.2, 524), Naphthalene (502.2), o-Xylene (502.2, 524), & Fecal Coliform (9222D).

The following analytes are Not Part of ELAP Solid and Hazardous Waste scope of accreditation:

Ammonia (SM 4500NH3G), TKN (351.2), Phosphorus (365.3), 1,2-Dichloro-1,1,2-trifluoroethane (8260), & Chlorodifluoromethane (8260).

The following analytes are Not Part of ELAP Non Potable Water scope of accreditation:

Dissolved Organic Carbon (5310C), Mecoprop (8151A), & MCPA (8151A).

Definitions and Glossary

Client: Sullivan County BOCES

Job Number:

Sdg Number: Monticello - High School

<u>Abbreviation</u>	<u>These commonly used abbreviations may or may not be present in this report.</u>
%R	Percent Recovery
DL, RA, RE	Indicates a Dilution, Reanalysis or Reextraction.
EPA	United States Environmental Protection Agency
MDL	Method Detection Limit - an estimate of the minimum amount of a substance that an analytical process can reliably detect. A MDL is analyte- and matrix-specific and may be laboratory-dependent.
ND	Not detected at the reporting limit (or MDL if shown).
QC	Quality Control
RL	Reporting Limit - the minimum levels, concentrations, or quantities of a target variable (e.g., target analyte) that can be reported with a specified degree of confidence.
RPD	Relative Percent Difference - a measure of the relative difference between two points.

1 of 2

108512-E

High School -- Lower Level

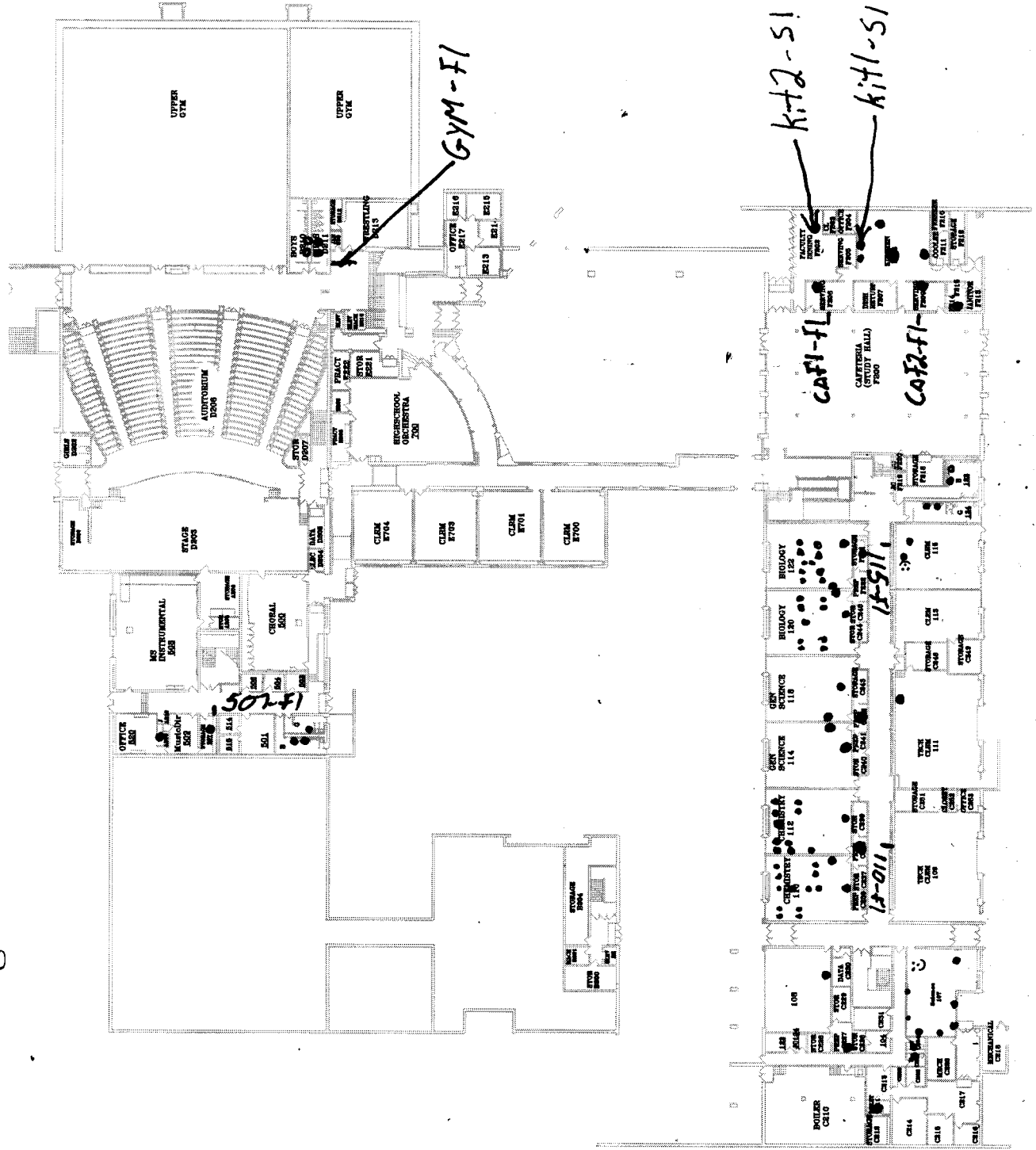

LOGIN SAMPLE RECEIPT CHECK LIST

Client: Sullivan County BOCES

Job Number: 420-108512-1
SDG Number: Monticello - High School

Login Number: 108512

Question	T/F/NA	Comment
Samples were collected by ETL employee as per SOP-SAM-1	NA	
The cooler's custody seal, if present, is intact.	NA	
The cooler or samples do not appear to have been compromised or tampered with.	True	
Samples were received on ice.	False	
Cooler Temperature is recorded.	True	25.4 C
Cooler Temp. is within method specified range.(0-6 C PW, 0-8 C NPW, or BAC <10 C	False	
If false, was sample received on ice within 6 hours of collection.	False	
Based on above criteria cooler temperature is acceptable.	True	Method does not require cooling. AE 8/8/16
COC is present.	True	
COC is filled out in ink and legible.	True	
COC is filled out with all pertinent information.	True	
There are no discrepancies between the sample IDs on the containers and the COC.	True	
Samples are received within Holding Time.	True	
Sample containers have legible labels.	True	
Containers are not broken or leaking.	True	
Sample collection date/times are provided.	True	
Appropriate sample containers are used.	True	
Sample bottles are completely filled.	True	
There is sufficient vol. for all requested analyses, incl. any requested MS/MSDs	True	
VOA sample vials do not have headspace or bubble is <6mm (1/4") in diameter.	NA	
If necessary, staff have been informed of any short hold time or quick TAT needs	True	
Multiphasic samples are not present.	True	
Samples do not require splitting or compositing.	True	